

TYPE 1 CROSS RECESS TRUSS HEAD MACHINE SCREW

XXXXPTMZ
APRIL, 2014
REV 00
PAGE 1 of 1

Nominal Screw Size	#0 Thru #12	1/4 Thru 3/4
Nominal Screw Length	Tolerance	
Up To & Including 1/2"	-0.02	-0.03
Over 1/2 To 1", Inclusive	-0.03	-0.03
Over 1" to 2", Inclusive	-0.06	-0.06
Over 2"	-0.09	-0.09

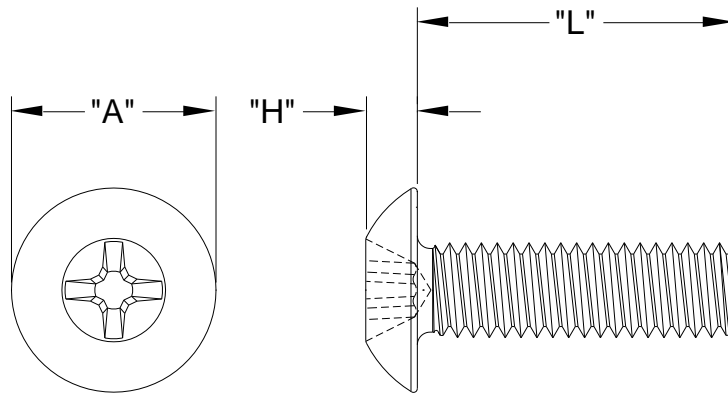

Nominal Screw Size	Basic Screw Size	Major Diameter		"A"		"H"		Driver Size	Recess Penetration Gaging Depth	
		Max.	Min.	Head Diameter		Head Height			Max.	Min.
				Max.	Min.	Max.	Min.			
#6 - 32	0.138	0.1380	0.1312	0.321	0.303	0.086	0.074	2	0.073	0.048
#8 - 32	0.164	0.1640	0.1571	0.384	0.364	0.102	0.088	2	0.088	0.063
#10 - 24	0.190	0.1900	0.1818	0.448	0.425	0.118	0.103	2	0.104	0.079
#10 - 32		0.1900	0.1831							
1/4 - 20	0.250	0.2500	0.2408	0.573	0.546	0.150	0.133	3	0.126	0.101
5/16 - 18	0.313	0.3125	0.3026	0.698	0.666	0.183	0.162	4	0.173	0.148
3/8 - 16	0.375	0.3750	0.3643	0.823	0.787	0.215	0.191	4	0.206	0.182

<p>Standard: ASME B18.6.3 Material: Carbon Steel, 60,000 psi Minimum Tensile Stress Finish: Commercial Zinc & ROHS Compliant Clear Chromate Per ASTM F1941 Code Fe/Zn 3A</p>	<p>Common Uses: Nuts, Tapped Holes, Threaded Inserts Low profile, large bearing surface; Excellent for softer materials; Weaker than Pan Head</p>
---	---