

SLOTTED INDENTED
HEX WASHER HEAD
TYPE "B" SMS

XXXXSHWBZ
Jan, 2020
REV 01
PAGE 1 of 1

Nominal Screw Length	Tolerance On Screw Length
Up To & Including 3/4"	-.030
Over 3/4 to 1-1/2"	-.050
Over 1-1/2"	-.060

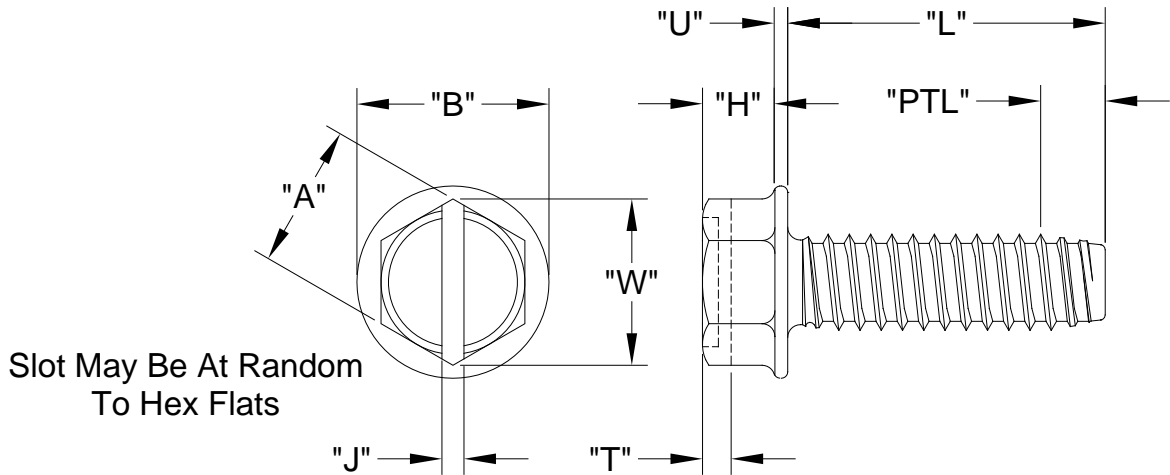

Nominal Screw Size	"D"		"d"		"W"		"A"		"H"		"B"		"U"		"J"		"T"	
	Major Diameter		Minor Diameter		Width Across Corners		Width Across Flats		Head Height		Washer Diameter		Washer Thickness		Slot Width		Slot Depth	
	Max.	Min.	Max.	Min.	Min.	Max.	Min.	Max.	Min.	Max.	Min.	Max.	Min.	Max.	Min.	Max.	Min.	Max.
#4-24	0.114	0.108	0.086	0.082	0.202	0.188	0.181	0.060	0.049	0.243	0.225	0.019	0.011	0.039	0.031	0.042	0.025	
#6-20	0.139	0.132	0.104	0.099	0.272	0.250	0.244	0.093	0.080	0.328	0.302	0.025	0.015	0.048	0.039	0.053	0.033	
#8-18	0.166	0.159	0.122	0.116	0.272	0.250	0.244	0.110	0.096	0.348	0.322	0.031	0.019	0.054	0.045	0.074	0.052	
#10-16	0.189	0.182	0.141	0.135	0.340	0.312	0.305	0.120	0.105	0.414	0.384	0.031	0.019	0.060	0.050	0.080	0.057	
1/4-14	0.246	0.237	0.192	0.185	0.409	0.375	0.367	0.190	0.172	0.520	0.480	0.050	0.030	0.075	0.064	0.111	0.083	

Standard: ASME B18.6.3
Material: Carbon Steel,
Heat Treat: Case Hardened
Finish: Commercial Zinc, Bake & ROHS Compliant Clear Chromate
Per ASTM F1941 Code Fe/Zn 3A

Common Uses:
Increased Bearing Surface w/o Adding A Washer.
Excellent For Softer Materials To Reduce Embedment;
Used In Soft Plastics, Soft Woods, Thin Sheet
Metal(<60% Of Major Dia.), Aluminum Extrusions