

SLOTTED FILLISTER HEAD MACHINE SCREW

XXXXSLMZ
APRIL, 2014
REV 00
PAGE 1 of 1

Nominal Screw Size	#0 Thru #12	1/4 Thru 3/4
Nominal Screw Length	Tolerance	
Up To & Including 1/2"	-0.02	-0.03
Over 1/2 To 1", Inclusive	-0.03	-0.03
Over 1" to 2", Inclusive	-0.06	-0.06
Over 2"	-0.09	-0.09

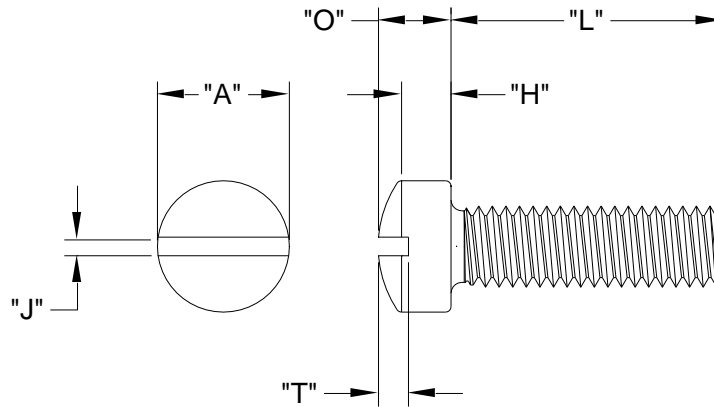

Nominal Screw Size	Basic Screw Size	Major Diameter		"A" Head Diameter		"H" Side Height		"O" Total Head Height		"J" Slot Width		"T" Slot Depth	
		Max.	Min.	Max.	Min.	Max.	Min.	Max.	Min.	Max.	Min.	Max.	Min.
		#6 - 32	0.138	0.1380	0.1312	0.226	0.208	0.096	0.086	0.132	0.111	0.048	0.039
#8 - 32	0.164	0.1640	0.1571	0.270	0.250	0.113	0.102	0.156	0.133	0.054	0.045	0.071	0.054
#10 - 24	0.190	0.1900	0.1818	0.313	0.292	0.130	0.118	0.180	0.156	0.060	0.050	0.083	0.064
#10 - 32		0.1900	0.1831										
1/4 - 20	0.250	0.2500	0.2408	0.414	0.389	0.170	0.155	0.237	0.207	0.075	0.064	0.109	0.087

<p>Standard: ASME B18.6.3 Material: Carbon Steel, 60,000 psi Minimum Tensile Stress Finish: Commercial Zinc & ROHS Compliant Clear Chromate Per ASTM F1941 Code Fe/Zn 3A</p>	<p>Common Uses: Nuts, Tapped Holes, Threaded Inserts Used in counter-bored holes; Can be assembled closed to flanges and raised surfaces.</p>
---	--